

# Wide range Warning Sirens

## MS22 Motorised Siren 130 decibel@1m



- Range up to 5000m\*
- Motor driven siren available with single or three phase motor
- Sound output 130dB @ 1m
- Low penetrating tone
- Weatherproof

Voltage	Running Current	Starting Current	Weight (kg)
240Vac 50Hz 1ph ±5%	13.1A	88A	47
415Vac 3ph 50Hz ±5%	4.3A	37A	37

\*Range based on sound level of 60dB at quoted distance, in still air at 20°C, with the siren mounted at 5m above ground level and without obstructions

Order Code: SHMS22-240vac

Order Code: SHMS22-415vac

### Specifications:

Sound output:	130dB @ 1m
Sound frequency:	475Hz
Motor power:	2.2kw
Protection:	IP55
Rating:	Continuous
Cable entry:	1 phase – 1 x M20 3 phase – 1 x M25
Construction:	Cast aluminium siren head, aluminium alloy motor

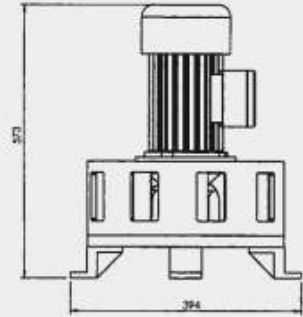

Dimensions in mm

## 3LF Motorised Siren 125 decibel@1m



- Range up to 3000m\*
- Single phase or 3ph motor driven siren
- Robust cast aluminium
- Sound output 125dB @ 1m
- Weatherproof

Voltage	Running Current	Starting Current
230VAC 50Hz 1ph ±5%	6.7A	37A
415VAC 50Hz 3ph ±5%	2.3A	17A

\*Range based on sound level of 60dB at quoted distance, in still air at 20°C, with the siren mounted at 5m above ground level and without obstructions.

Order Code: SH3LF-240vac

Order Code: SH3LF-415vac

### Specifications:

Sound output:	125dB @ 1m
Sound frequency:	560Hz
Motor power:	1.1kw
Protection:	IP55
Rating:	Continuous
Cable entry:	1 phase – 1 x M20 3 phase – 1 x M25
Construction:	Cast aluminium siren head, aluminium alloy motor, steel base
Weight:	22Kg

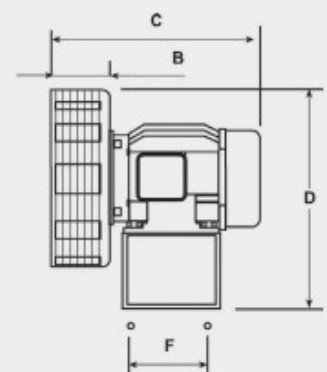
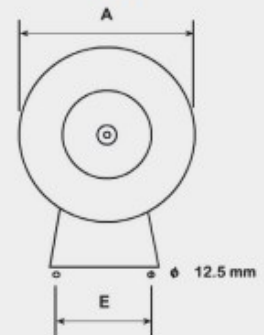

Dimensions in mm

Email enquires to [sales@sirens.com.au](mailto:sales@sirens.com.au)

