

Nexus 105/110/120 Sounder Beacon

High output sounder beacons certified to EN54.

Connections are made to the base during the initial wiring phase which results in faster and more reliable installation. In addition, the head is fixed by quarter turn fasteners avoiding the need to screw up four individual screws thus enabling faster installation and accurate seal compression for weatherproofing.

The Nexus Sounder Beacon is available with a high efficiency LED or high output xenon beacon. The combination of a powerful sounder and high output beacon ensures a very effective audio-visual signal. 110dB and 120dB units, as well as AC variants, are also available.

Features

- 5J xenon or high efficiency LED beacon option
- Quarter turn fasteners for ease of installation
- First-fix, wire to base technology
- IP66 rated
- Three alarm stages
- Low in-rush current (LED only)
- Static/flashing mode (LED only)
- Volume control for greater flexibility - 20dB
- 64 tones
- Voltage 10-60V DC

Lens Colour Options



Nexus 105

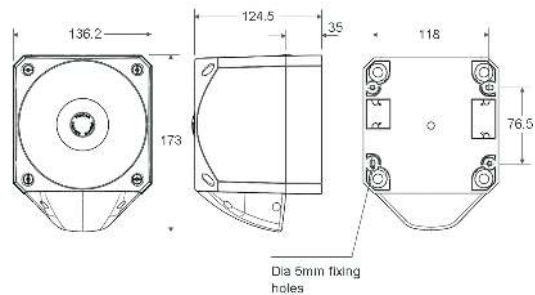

Nexus 110/120

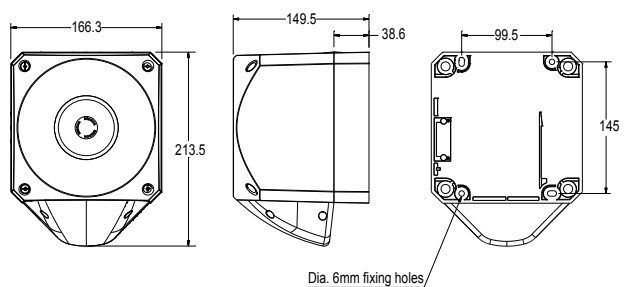

Specifications

| 105dB Part No. | 110dB Part No. | 120dB Part No. | Lens Colour | Beacon Type | Beacon Current | 105db Sounder Current | 110db Sounder Current | 120db Sounder Current |
|----------------|----------------|----------------|-------------|-------------|----------------|-----------------------|-----------------------|-----------------------|
| PNC-0001 | PNC-0013 | PNC-0003 | Red | Xenon | 330mA@24V DC | 8-40mA | 10-50mA | 120-550mA |
| PNC-0002 | PNC-0015 | PNC-0004 | Amber | Xenon | 330mA@24V DC | 8-40mA | 10-50mA | 120-550mA |
| PNC-0020 | PNC-0021 | PNC-0022 | Clear | Xenon | 330mA@24V DC | 8-40mA | 10-50mA | 120-550mA |
| PNC-0043 | PNC-0050 | PNC-0057 | Blue | Xenon | 330mA@24V DC | 8-40mA | 10-50mA | 120-550mA |
| PNC-0041 | PNC-0048 | PNC-0055 | Green | Xenon | 330mA@24V DC | 8-40mA | 10-50mA | 120-550mA |
| PNC-0024 | PNC-0029 | PNC-0035 | Red | LED | 18mA/65mA** | 8-40mA | 10-50mA | 120-550mA |
| PNC-0028 | PNC-0034 | PNC-0039 | Amber | LED | 18mA/65mA** | 8-40mA | 10-50mA | 120-550mA |
| PNC-0045 | PNC-0052 | PNC-0059 | Clear | LED | 18mA/65mA** | 8-40mA | 10-50mA | 120-550mA |
| PNC-0047 | PNC-0054 | PNC-0061 | Blue | LED | 18mA/65mA** | 8-40mA | 10-50mA | 120-550mA |
| PNC-0046 | PNC-0053 | PNC-0060 | Green | LED | 18mA/65mA** | 8-40mA | 10-50mA | 120-550mA |

** Flashing/Static current consumption figures.

IP Rating: IP66 **Rating:** Continuous **Frequency:** See Tone Table
Operating Temp: -25°C to +70°C **Cable Entries:** 5 **Compliance:** EN54-3 Type B
Weight: Nexus 105: 0.8kg; Nexus 110: 1.2kg; Nexus 120: 2.0kg
Current Sounder: Nexus 105: 8-40mA; Nexus 110: 10-50mA; Nexus 120: 120-550mA